

Porenbeton- Luftschichtanker Typ PB 10 Cavity wall tie model PB 10

Montagehinweis Installation

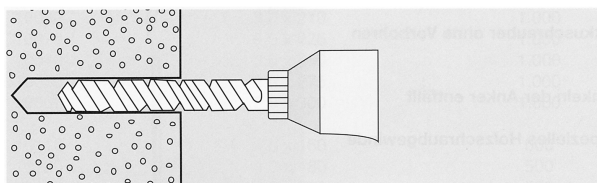

Mit Bohrer 10 mm Ø Loch bohren
Drill a hole using a steel drill with a
dia. of 10 mm

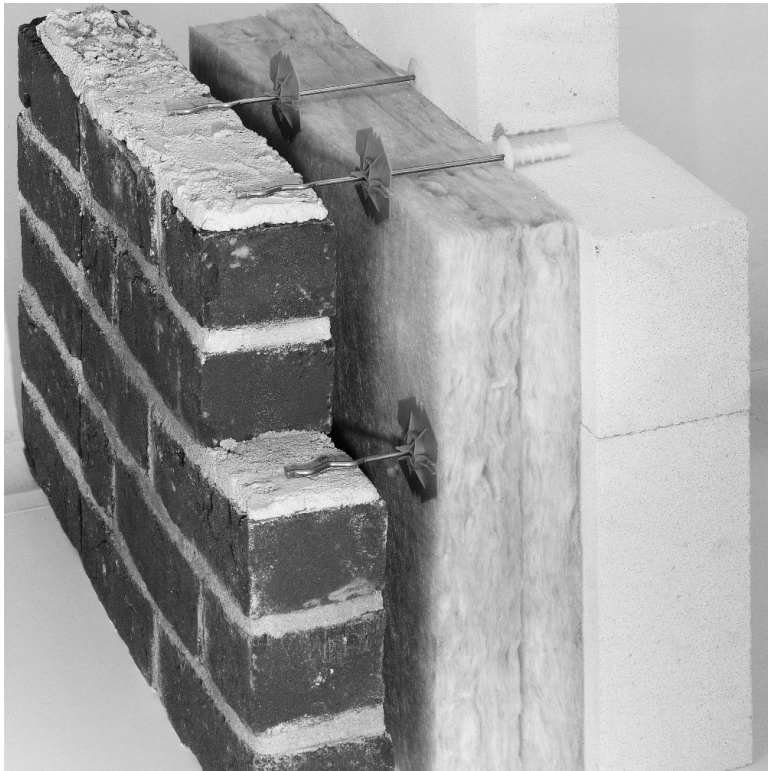
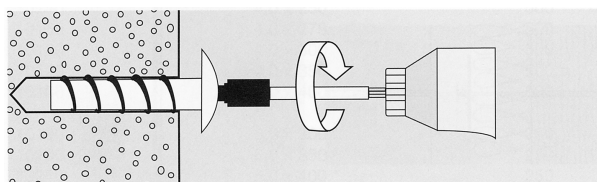

Dübel mit Eindrehadapter und
Schraubwerkzeug eindrehen.
Insert the plug using the screw
adapter and screwdriver.

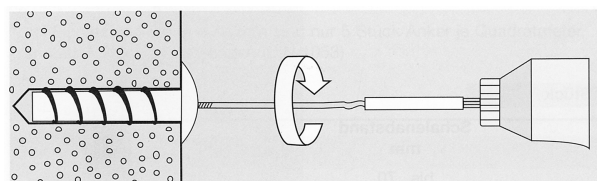

Anker mit Adapter in den gesetzten
Dübel einschrauben.
Use the adapter to screw the
anchor into the plug. Due to the
wavy end there is no need to bend
it into the outer leaf.